

GENERAL NOTES

- 1/ For General Tiling Arrangement Details Refer to Drawing No. MDL/A/1/44/02
- 2/ For Pilaster Base Detail 03 Refer to Drawing No. MDL/X/00/44/03
- 3/ For Section Detail A-A Refer to Drawing No. MDL/X/0/44/01

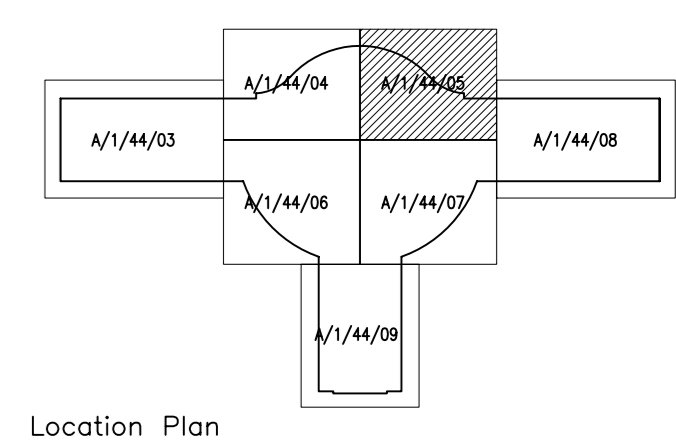

Location Plan 1:1000

| REV. | DESCRIPTION | DATE |
|------|-------------|------|
| | | |

No. Additional 597x597mm Azul Macabre Plain Tile (Number A1740) to be Ordered to Cut on Site to Allow for Any Escalator Positional Tolerances.

All Stones at Junction of Escalator to be Manufactured 75mm Oversized & Cut on Site to Suit As-Built Details.

PEEL AVENUE

COPYRIGHT AND OWNERSHIP OF THIS DRAWING IS VESTED IN THE COMPANY NAMED ON THE DRAWING, WHOSE PRIOR WRITTEN CONSENT IS REQUIRED FOR ITS USE, REPRODUCTION OR FOR PUBLICATION TO ANY THIRD PARTY. RIGHTS RESERVED BY LAW OR COMMON LAW AND INTERNATIONAL COPYRIGHT CONVENTIONS ARE REFERRED TO THE COMPANY NAMED ON THIS DRAWING AND MAY BE PROTECTED BY COURT PROCEEDINGS FOR DAMAGES AND/OR INJUNCTIONS AND COSTS.



PROJECT
The Trafford Centre, Manchester

TITLE
Zone A1, Tiling General Arrangement Sheet 1 / 4

SCALE 1:25 DATE May 1997
DRAWN G. Taylor C.A.D. REF. Drawing07.dwg

MDL/TC/A1/44/05